

Material Specifications

ITEM	DESCRIPTION	MATERIAL	QTY.
1	BODY	S.ST. ASTM A351 CF8M	1
2	BODY CONNECTOR	S.ST. ASTM A351 CF3M	1
3	BALL (WITH RELIEF HOLE)	S.ST. 316 ASTM A276	1
4	STEM	S.ST. 17-4PH	1
5	SEAT RING	PCTFE, NRG	2
6	BODY SEAL	PTFE	1
7	THRUST SEAL	PTFE CARBON FILLED	1
8	BOTTOM GLAND PACKING	PTFE	1
8a	MIDDLE GLAND PACKING	PTFE	3
8b	TOP GLAND PACKING	PTFE	1
9	GLAND	S.ST. 316L ASTM B783	1
10	DISC SPRING GLAND NUT	S.ST. 17-7PH	2
11	GLAND NUT	S.ST. 316 ASTM A194	1
12	LOCKING CLIP	S.ST. 304 ASTM A164	1
13	HANDLE	S.ST. 430 ASTM A240	1
14	SERRATED WASHER	S.ST. 410	1
15	HANDLE NUT	S.ST. 316 ASTM A194	1
16	STOP PIN	S.ST. 303 ASTM A582	1
17	HANDLE SLEEVE WHITE	VINIL PLASTISOL	1
18	TOP FLANGE SEAL	PTFE	1
19	TOP FLANGE	S.ST. 316 ASTM A276	1
20	TOP FLANGE BOLTS	S.ST. A2-70 ISO 4014	4
21	STEM BEARING	PTFE	1
22	BODY CONNECTOR BOLTS	S.ST. A2-70 ISO 4014	4
23	BODY CONNECTOR SPRING	S.ST.	4
24	BODY CONNECTOR NUTS	S.ST. A4-70 ISO 4032	4

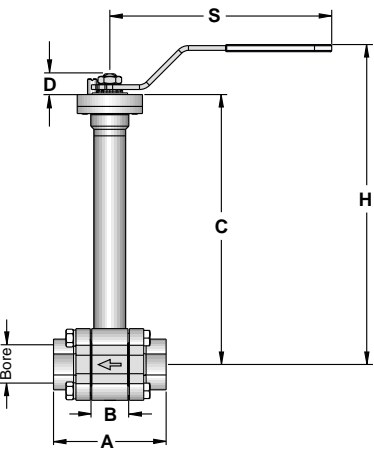
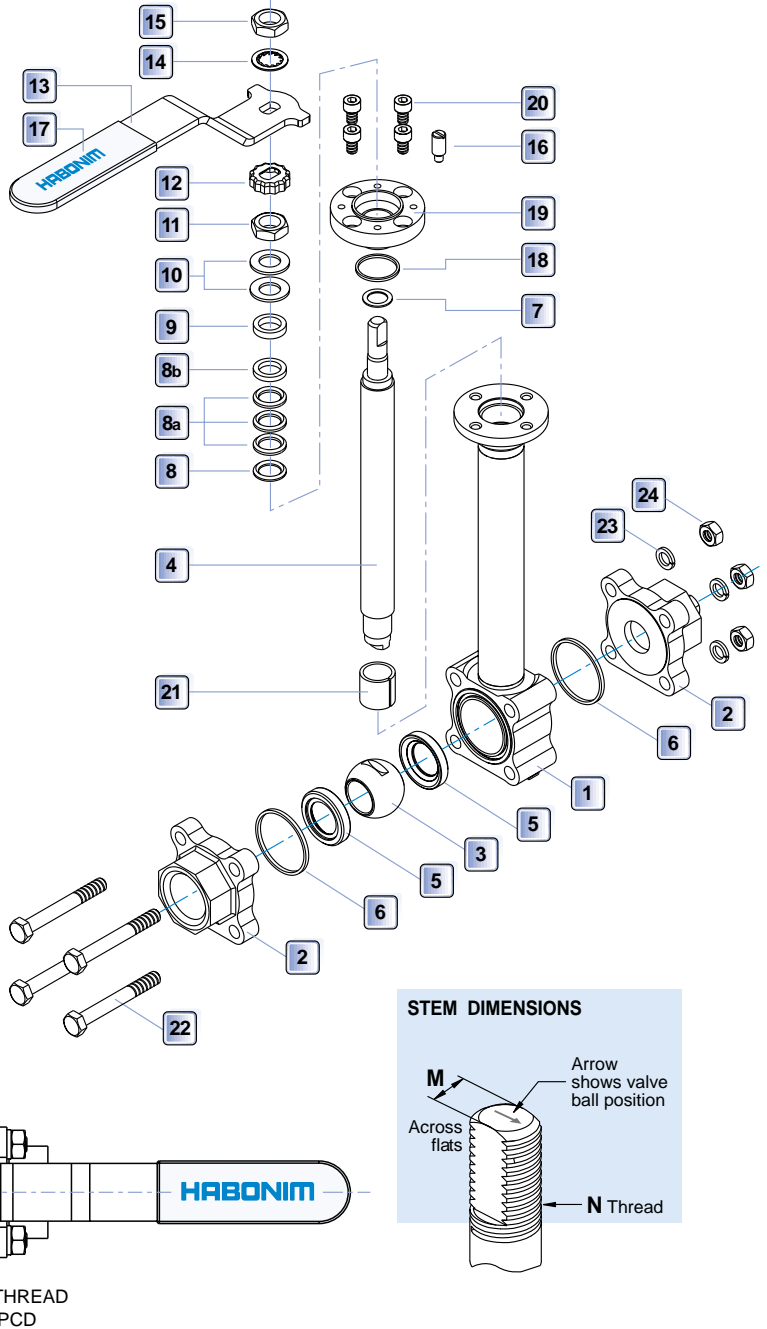

Valve Dimensions 1/2" - 2 1/2"

SIZE	UNIT	BORE	A	B	C	D	H	S	W	M	N	T	F (ISO)
1/2"	mm	11.1	66	20.6	208	9.0	242	150	47.0	5.5	3/8"	M5	36.0 (F03)
	inch	0.44	2.598	0.811	8.189	0.354	9.528	5.906	1.850	0.217	UNF	M5	1.42
3/4"	mm	14.3	71	24.5	210	9.0	244	150	53.7	5.5	3/8"	M5	36.0 (F03)
	inch	0.56	2.795	0.965	8.268	0.354	9.606	5.906	2.114	0.217	UNF	M5	1.42
1"	mm	20.6	95	31.7	227	17.5	273	187	63.7	7.54	7/16"	M5	42.0 (F04)
	inch	0.81	3.740	1.248	8.937	0.689	10.748	7.362	2.507	0.297	UNF	M5	1.65
1 1/4"	mm	25.4	108	40.9	233	17.5	275	187	71.7	7.54	7/16"	M5	42.0 (F04)
	inch	1.00	4.252	1.610	9.173	0.689	10.827	7.362	2.822	0.297	UNF	M5	1.65
1 1/2"	mm	31.8	115.5	48.4	270	29.5	320	237	86.7	8.71	9/16"	M6	50.0 (F05)
	inch	1.25	4.547	1.906	10.630	1.161	12.598	9.331	3.413	0.343	UNF	M6	1.97
2"	mm	38.1	128	56.3	275	29.5	326	237	96.9	8.71	9/16"	M6	50.0 (F05)
	inch	1.50	5.039	2.217	10.827	1.161	12.835	9.331	3.815	0.343	UNF	M6	1.97
2 1/2"	mm	50.8	158	72.6	296.5	41.5	342	237	108	8.71	9/16"	M8	70.0 (F07)
	inch	2.50	6.220	2.858	11.673	1.634	13.465	9.331	4.252	0.343	UNF	M8	2.75



Material Specifications

ITEM	DESCRIPTION	MATERIAL	QTY.
1	BODY	S.ST. ASTM A351 CF8M	1
2	INSERT	S.ST. ASTM A351 CF8M	1
3	BALL (WITH RELIEF HOLE)	S.ST. 316 ASTM A276	1
4	STEM	S.ST. 17-4PH	1
5	SEAT RING	PCTFE, NRG	2
6	BODY SEAL	PTFE	1
6a	BODY SEAL METAL RING	S.ST. 316 ASTM 276	1
7	THRUST SEAL	PTFE CARBON FILLED	1
8	BOTTOM GLAND PACKING	PTFE	1
8a	MIDDLE GLAND PACKING	PTFE	3
8b	TOP GLAND PACKING	PTFE	1
9	GLAND	S.ST. 316L ASTM B783	1
10	DISC SPRING GLAND NUT	S.ST. 17-7PH	2
11	GLAND NUT	S.ST. 316 ASTM A194	1
12	LOCKING CLIP	S.ST. 304 ASTM A164	1
13	HANDLE	S.ST. 430 ASTM A240	1
14	SERRATED WASHER	S.ST. 410	1
15	HANDLE NUT	S.ST. 316 ASTM A194	1
16	STOP PIN	S.ST. 303 ASTM A582	1
17	HANDLE SLEEVE WHITE	VINIL PLASTISOL	1
18	TOP FLANGE SEAL	PTFE	1
19	TOP FLANGE	S.ST. 316 ASTM A276	1
20	TOP FLANGE BOLTS	S.ST. A2-70 ISO 4014	4
21	STEM BEARING	PTFE	1

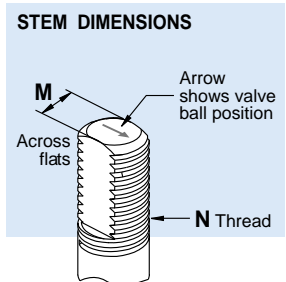
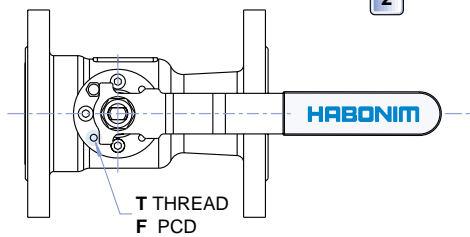
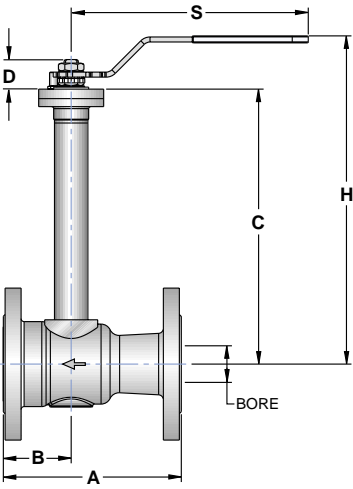
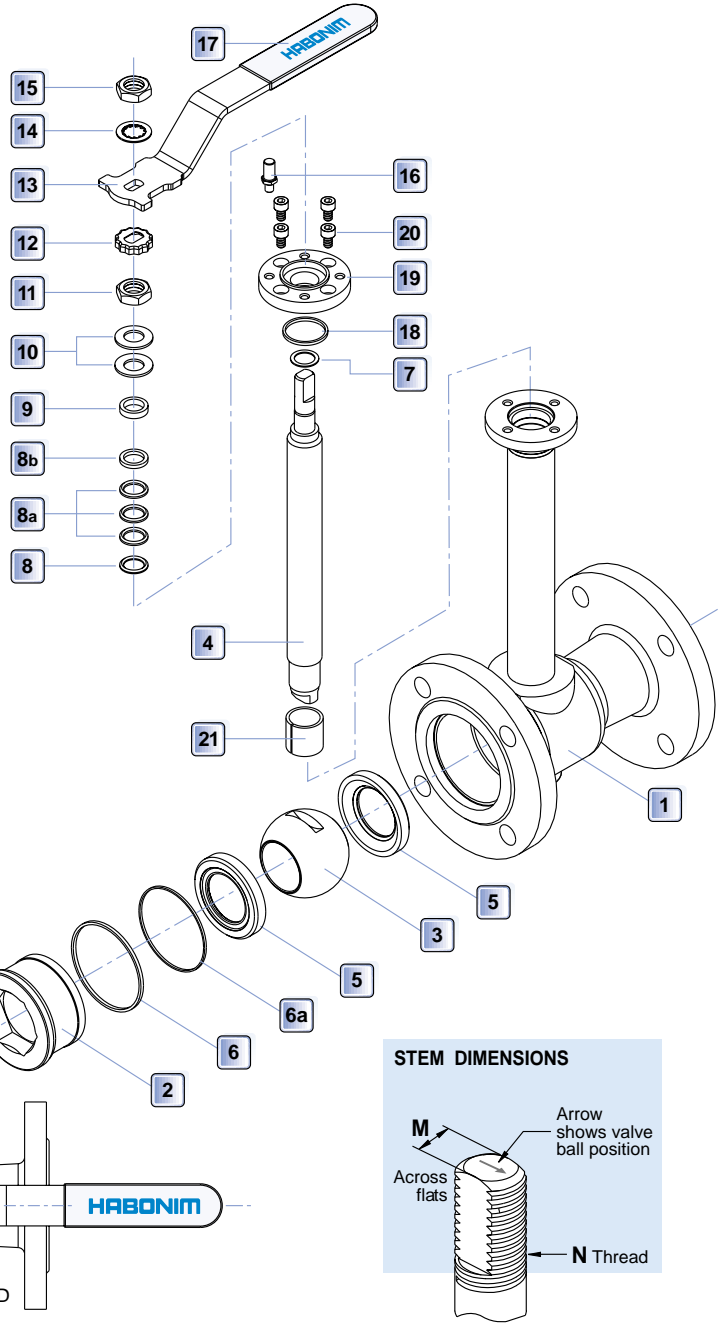

Valve Dimensions 1/2" - 2"

VALVE SIZE	BORE	A		B	C	D	H	S	M	N	T	F (Iso)	
		150	300										
1/2"	mm	11.1	108.0	140	46.0	29.0	38.0	92.0	151.0	5.54	3/8"	M5	36.0 (F03)
	in	0.44	4.25	5.5	1.81	1.14	1.5	3.62	5.94	0.218	UNF		1.42
3/4"	mm	14.3	117.0	152.0	49.3	31.4	40.3	94.0	151.0	5.54	3/8"	M5	36.0 (F03)
	in	0.56	4.61	6.0	1.94	1.24	1.59	3.7	5.94	0.218	UNF		1.42
1"	mm	20.6	127.0	165.0	57.2	38.2	55.6	103.5	170.0	7.54	7/16"	M5	42.0 (F04)
	in	0.81	5.0	6.5	2.25	1.50	2.19	4.07	6.69	0.296	UNF		1.65
1 1/2"	mm	31.8	165.0	190.0	62.3	43.6	73.1	119.2	220.5	8.7	9/16"	M6	50.0 (F05)
	in	1.25	6.5	7.5	2.45	1.72	2.88	4.7	8.68	0.343	UNF		1.97
2"	mm	38.1	178.0	216.0	67.8	48.3	77.8	123.9	220.5	8.7	9/16"	M6	50.0 (F05)
	in	1.50	7.0	8.5	2.67	1.90	3.06	4.88	8.68	0.343	UNF		1.97